



**STAINLESS STEEL**

**150 LBS SCREWED FITTINGS**

**BSPP (ISO 228-1), BSPT (ISO 7-1), NPT THREAD**

DIMENSION CONFORM TO ASME B16.3 AND ANSI/MSS SP-114-2018 WHERE APPLICABLE

MATERIAL CONFORM TO ASTM A351 GR. CF8 & CF8M

PRESSURE-TEMPERATURE RATINGS 300 PSI (-29 TO 66°C)

MADE BY LOST WAX INVESTMENT CASTING

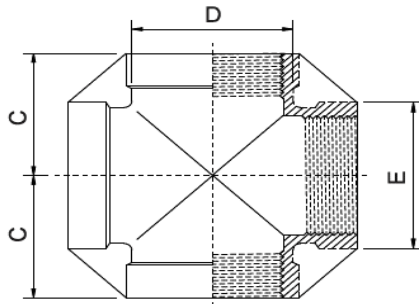

## CROSS

SIZE	C	D	E	Weight
	(mm)	(mm)	(mm)	(Kg/Pc)
1/8"	16.5	12.9	14.2	0.040
1/4"	18.3	15.8	17.3	0.050
3/8"	21.0	19.0	20.9	0.060
1/2"	26.3	24.7	26.8	0.110
3/4"	30.5	30.3	32.3	0.170
1"	35.6	38.1	39.8	0.260
1 1/4"	42.5	45.7	49.0	0.400
1 1/2"	44.8	53.0	55.8	0.540
2"	56.0	65.0	68.0	0.830
2 1/2"	67.4	85.5	90.0	1.740
3"	74.5	95.7	100.0	1.862
4"	90.4	122.5	127.0	3.240