

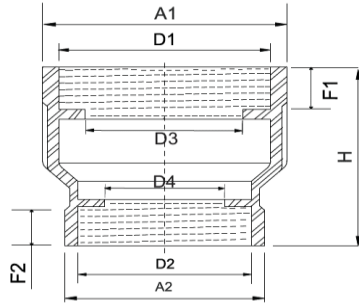

STAINLESS STEEL SOCKET WELDED FITTINGS

DIMENSION CONFORM TO ANSI/MSS SP-114-2018
 MATERIAL CONFORM TO ASTM A351 GR. CF8 & CF8M
 PRESSURE-TEMPERATURE RATINGS 300 PSI (-29 TO 66°C)
 MADE BY LOST WAX INVESTMENT CASTING



SOCKET WELD REDUCED COUPLING

Size	A1	A2	H	D1	D2	F1	F2	Weight (Kg/Pc)
	(mm)	(mm)	(mm)	(mm)	(mm)	(mm)	(mm)	
¼" x ⅛"	17.3	14.0	26.6	14.4	11.0	7.0	7.0	0.02
⅜" x ⅛"	21.0	14.0	28.9	17.7	11.0	8.0	7.0	0.03
⅜" x ¼"	21.0	18.0	29.0	17.7	14.4	8.0	7.0	0.03
½" x ⅛"	26.8	14.0	34.2	22.0	11.0	8.0	7.0	0.04
½" x ¼"	26.8	18.0	34.2	22.0	14.4	8.0	7.0	0.05
½" x ⅜"	26.8	21.0	34.7	22.0	17.7	8.0	8.0	0.05
¾" x ¼"	32.3	18.0	34.7	27.5	14.4	10.0	7.0	0.05
¾" x ⅜"	32.3	21.0	36.7	27.5	17.7	10.0	8.0	0.05
¾" x ½"	32.3	26.8	36.7	27.5	22.0	10.0	8.0	0.07
1" x ⅜"	39.8	21.0	42.0	34.2	17.7	10.0	8.0	0.08
1" x ½"	39.8	26.8	42.2	34.2	22.0	10.0	8.0	0.09
1" x ¾"	39.8	32.3	42.2	34.2	27.5	10.0	10.0	0.09
1¼" x ⅜"	49.0	21.0	45.0	43.0	17.7	12.0	8.0	0.09
1¼" x ½"	49.0	26.8	46.2	43.0	22.0	12.0	8.0	0.11
1¼" x ¾"	49.0	32.3	46.2	43.0	27.5	12.0	10.0	0.11
1¼" x 1"	49.0	39.8	47.0	43.0	34.2	12.0	10.0	0.12
1½" x ½"	55.8	26.8	47.3	49.0	22.0	12.0	8.0	0.13
1½" x ¾"	55.8	32.3	49.5	49.0	27.5	12.0	10.0	0.13
1½" x 1"	55.8	39.8	50.0	49.0	34.2	12.0	10.0	0.16
1½" x 1¼"	55.8	49.0	51.7	49.0	43.0	12.0	12.0	0.17
2" x ½"	68.0	27.0	55.0	61.2	22.0	13.0	8.0	0.20
2" x ¾"	68.0	32.0	55.0	61.2	27.5	13.0	10.0	0.21
2" x 1"	68.0	39.8	55.0	61.2	34.2	13.0	10.0	0.24
2" x 1¼"	68.0	49.0	58.0	61.2	43.0	13.0	12.0	0.26
2" x 1½"	68.0	55.8	58.0	61.2	49.0	13.0	12.0	0.29
2½" x 1"	90.0	40.0	61.2	74.2	34.2	19.0	10.0	0.59
2½" x 1¼"	90.0	49.0	61.2	74.2	43.0	19.0	12.0	0.59
2½" x 1½"	90.0	55.8	60.5	74.2	49.0	19.0	12.0	0.60
2½" x 2"	90.0	68.0	61.0	74.2	61.2	19.0	13.0	0.62
3" x 1"	100.0	40.0	62.4	90.0	34.2	21.0	10.0	0.59
3" x 1¼"	100.0	49.0	63.5	90.0	43.0	21.0	12.0	0.74
3" x 1½"	100.0	55.8	63.5	90.0	49.0	21.0	12.0	0.69
3" x 2"	100.0	68.0	65.5	90.0	61.2	21.0	13.0	0.81
3" x 2½"	100.0	90.0	70.0	90.0	74.2	21.0	19.0	0.94
4" x 1½"	127.0	55.8	71.0	115.5	49.0	22.0	12.0	1.30
4" x 2"	127.0	68.0	71.0	115.5	61.2	22.0	13.0	1.30
4" x 2½"	127.0	90.0	71.5	115.5	74.2	22.0	19.0	1.38
4" x 3"	127.0	100.0	76.5	115.5	90.0	22.0	21.0	1.42